

G01
 0.7mm STEEL TRIMLINE GUTTER
 • FINISH: HPS200
 • COLOUR: ALBATROSS 18B17

AG00
 GUTTER SUPPORT ARM CLAMP
 • COLOUR: GOOSEWING GREY BS10A05
 • FINISH: HPS200 ULTRA

GUN GRADE SEALANT AT PANEL
 JOINT INLINE WITH INTERNAL AIR
 SEAL. SINGLE LINE OF NON-SETTING
 GUN-GRADE

TATA STEEL TRISOMET 333 COMPOSITE ROOF PANEL:
 • 0.5mm THK STEEL OUTER SKIN.
 • COLOUR: BS 10A05 GOOSEWING GREY
 • FINISH: HPS200 ULTRA
 • 120mm THK LPC CLASS B INSULATION CORE.
 • 0.4mm THK STEEL WHITE POLYESTER LINER.

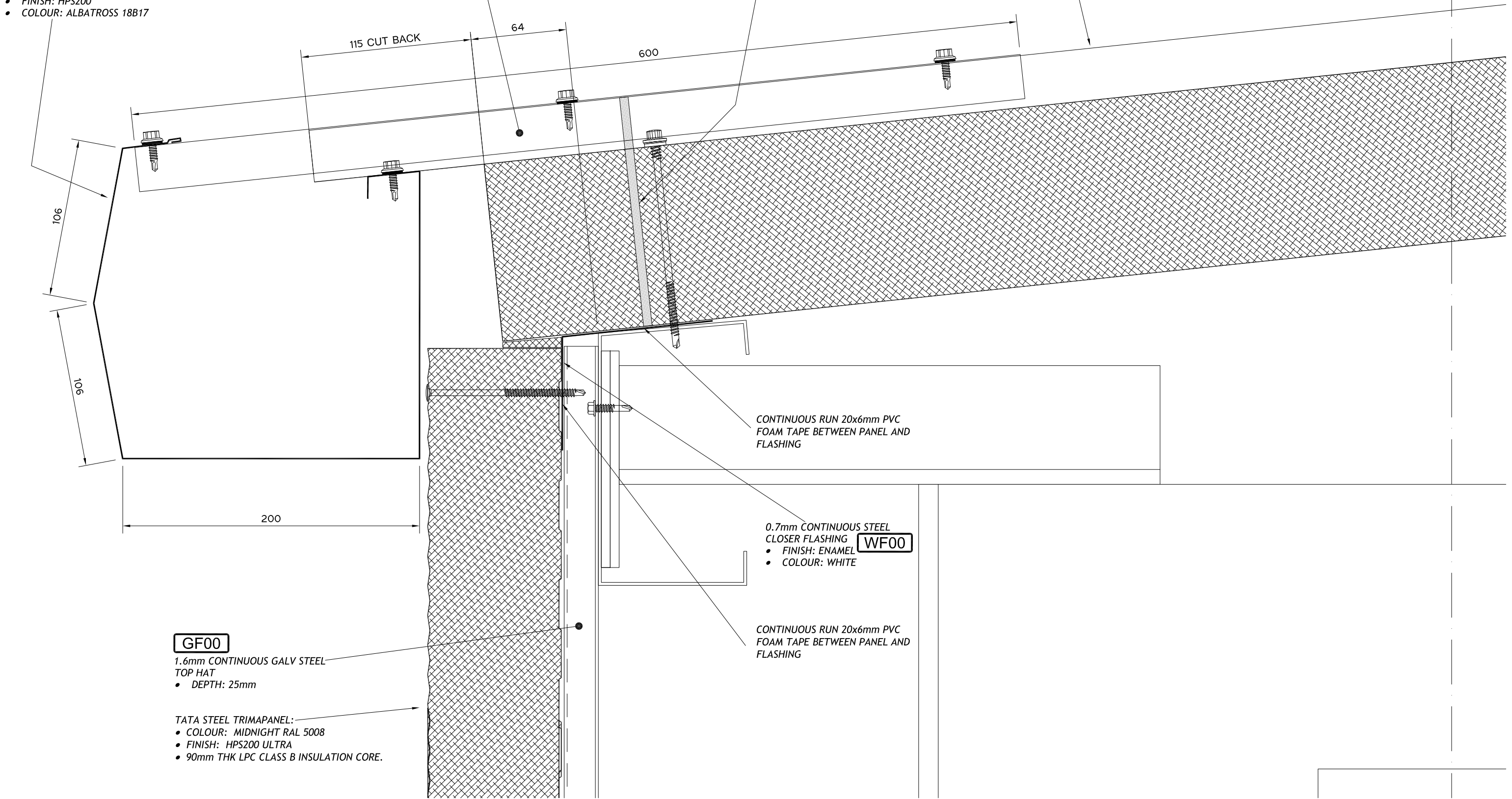

GF00
 1.6mm CONTINUOUS GALV STEEL
 TOP HAT
 • DEPTH: 25mm

TATA STEEL TRIMAPANEL:
 • COLOUR: MIDNIGHT RAL 5008
 • FINISH: HPS200 ULTRA
 • 90mm THK LPC CLASS B INSULATION CORE.

CONTINUOUS RUN 20x6mm PVC
 FOAM TAPE BETWEEN PANEL AND
 FLASHING

0.7mm CONTINUOUS STEEL
 CLOSER FLASHING **WF00**
 • FINISH: ENAMEL
 • COLOUR: WHITE

CONTINUOUS RUN 20x6mm PVC
 FOAM TAPE BETWEEN PANEL AND
 FLASHING

REVISION / AUTHOR / CHECKER C1 - ISSUED FOR CONSTRUCTION - 22 JULY 16 P1-ISSUED FOR APPROVAL - 01 JULY 16	PL	PL	DRAWN BY: PL	PROJECT TITLE: THURMASTON - WICKES PLOT 2A	STATUS: CONSTRUCTION
	P	AL	SCALE @ A3: 1:2.5	DRAWING TITLE: EAVES DETAIL	REV: C1
					DRAWING NO: 365-D01